

**SIEMENS**  
*Ingenuity for life*

New



The worldwide  
standard for  
home and  
building control



# GAMMA Training Kit GTK 5.1 Update 2018/08

# GAMMA Training Kit GTK5.1 - *Classic Basic!*

**GTK5.1 - *Classic Basic*** – delivery status will be like this:



GTK5.1 – ***Classic Basic*** with Module 110  
Order number: E10003-C38-7S-K0110

or



GTK5.1 – ***Classic Basic*** with Module 120  
Order number: E10003-C38-7S-K0120

# GTK5.1 – Room Simulation and Function and Operation Modules (FOM)

## Function- and Operating Modules (FOM)

predefined:



Simulation switches for window and wind condition

Not defined:



Room simulation



The room model represents the situation of an office floor, consisting of two rooms and a staircase. Lighting can be switched and dimmed, there are blinds, designed as an electronic simulation with the help of LED rows, as well as the simulation of heating and cooling.

For the operation of the room model, a number of predefined function and operating modules (FOM) are available as well as undefined plates. With the undefined FOM the desired devices have to be ordered separately. However, the connecting electronics are included in the GTK, so the connection sockets are already provided under the cover.

## GTK5.1 - Function and Operation Modules (FOM)

M110



M120



M131



M220



M320



M410



M710

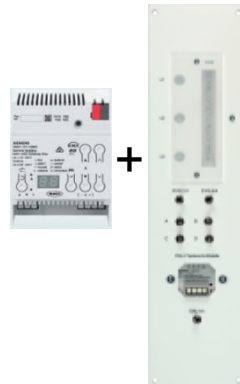

M720



The equipment of the Training Kits with function and operating modules (FOM) is not predefined in the basic equipment, but can be extended as desired with orderable FOM.

Modules 110 or 120 are mandatory because of the control of the window/wind simulation (difference: M110 with triple rocket, M120 with AQR air quality controller).

In the GTK, there are free module slots for your own design and the following modules to choose from:

- M410 Touch Panel
- KNX M710 DALI

New are the following modules:

- M131 push button and presence detector
- M220 constant light control module. This is useful in conjunction with M710 because it also contains a DALI sensor.
- M320 room control unit including climate controller
- M720 4-fold LED dimmer module with light source

## GTK5.1 - Function and Operation Modules (FOM) – Phasing out

M130

**Phase out!**



M210

**Phase out!**



M310

**Phase out!**



While supplies last, the M130 module with two triple pushbuttons and one motion detector, the M210 module with only one motion detector and the M310 Contouch module are available.

GTK 5.0 modules have a screw fixing (no bayonet fixing) !!

## New Mounting System: Camlock – Bayonet Fixing



**SIEMENS**  
*Ingenuity for life*



Since the update to GTK 5.1, the module plates have a bayonet quick fixing

### **Be careful when reordering FOM!**

Please indicate, if you need FOM for the GTK 5.0 and therefore no bayonet fixing! If you have a GTK model with screw fixing, please mention this when ordering FOM, so that we can manufacture and deliver the FOM with the appropriate holes.

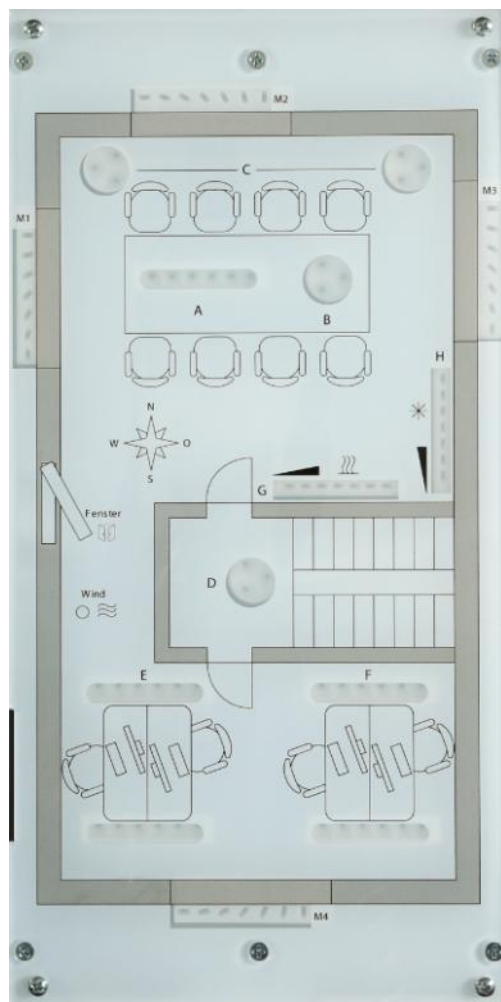

The room model in the GAMMA Training Kit enables to show all KNX functions such as:

- Lighting group A & B above a meeting table
- Lighting group C in a meeting room
- Lighting D in the staircase
- Office room lighting E and F
- Blinds on four sides M1, M2, M3 and M4
- Wind sensor simulation
- Window open / closed
- Heating radiator G with red LED strip
- Cooling element H with blue LED strip

## Mounted FOM

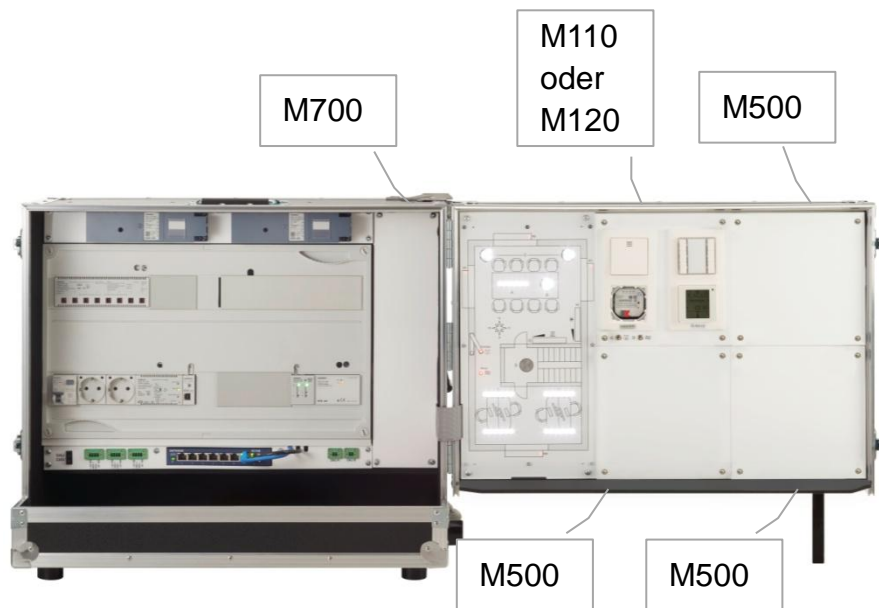

The demo case GTK5.1 - **Classic Basic** comes with already mounted Module M110 or M120. The other sections are covered with blank plates.



## Optional FOM

The GTK5.1 - **Classic Basic** can optionally be extended with the following FOM: M131, M220, M320 and M410, the DALI-Module M710 and M720.





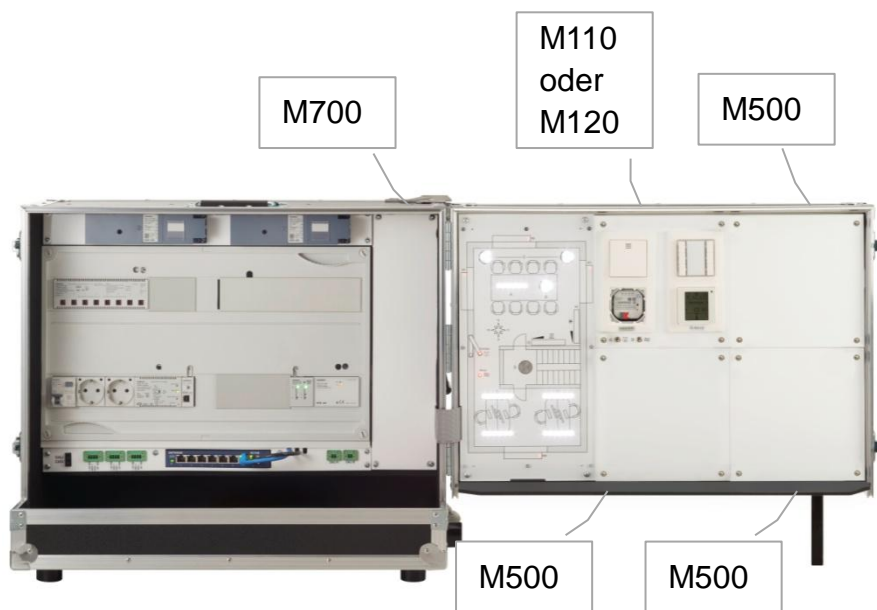

## Devices mounted in *Classic Basic*

## Functions

- Power supply unit N 125/22
- USB-Interface N 148/12
- IP-Router N 146/02
- IP Control Center N 152
- 8-port network switch 10/100 Mbit/s
- 3 x KNX connection sockets
- 2 x DALI connection sockets (prepared for DALI)
- Switching/dimming, heat & cool with N 526E02
- 4 x blinds with 2x RL 521/23 with AP 118
- Pushbutton interface UP 220D31
- Pushbutton with LED via UP 220D31
- Room control unit with display UP 227
- BTM, i-system pushbutton, LED, white UP 223/13

- Switching, dimming, solar protection, set value, central function
- Heating and cooling with room control unit UP 227
- Window contact
- information display and weekly schedule programs with room control unit UP 227
- KNX/IP communication
- Alarm function „wind“
- Web visualization and application modules with scheduler programm, scene module and logic function with the IP Control Center N 152



**Beate Marquart**  
BT CPS SRA BLC  
Siemensstr. 10  
93055 Regensburg  
Deutschland

Tel.: +49 / 941 790-10200  
Mobil: +49 / 173 2556352

E-mail:  
[beate.marquart@siemens.com](mailto:beate.marquart@siemens.com)

**Günter Birner**  
BT CPS S&C MK&B TR TD  
Siemensstr. 10  
93055 Regensburg  
Deutschland

Tel.: +49 941 790-2071  
Mobil: +49 / 162 2559099

E-mail:  
[guenter.birner@siemens.com](mailto:guenter.birner@siemens.com)